

# HexLobe<sup>®</sup> Punches

HexLobe<sup>®</sup> is a registered trademark of Wrentham Tool Group

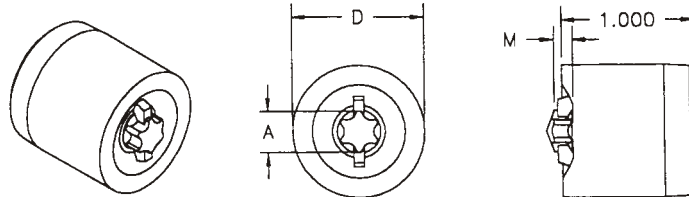

Hexlobe<sup>®</sup> is a complete line of tooling designed for the manufacture of hexalobular internal driving features for bolts and screws in accordance with the International Standard ISO 10664

Hexlobe<sup>®</sup> can be made to meet other standards and custom designs

Most popular sizes are stocked for your needs

Available in M2 and M42- other materials upon request

Available with PVD coatings and uncoated

Please contact Wrentham Customer Service for your specific needs:

(508)-966-2332

Or email: [customerservice@wrenthamtool.com](mailto:customerservice@wrenthamtool.com)

**WARNING**

Any heading punch may break or shatter under improper use. Government regulations require use of safety glasses and other appropriate safety equipment at all times in the vicinity of use.