

## FLAT TORX® PUNCHES

### ONE PIECE FLAT TORX® PUNCHES TXP-21.1

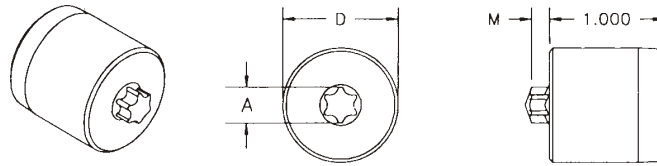

#### T10

PIN NUMBER	M +0.003	A REF	D REF
10-TXI-150	0.055		
10-TXI-151	0.047		
10-TXI-152	0.065		
10-TXI-153	0.040	0.1110	0.5625
10-TXI-154	0.053		
10-TXI-155	0.037		
10-TXI-156	0.030		

#### T27

PIN NUMBER	M +0.003	A REF	D REF
27-TXI-150	0.125		
27-TXI-151	0.077		
27-TXI-152	0.110	0.2005	0.8750
27-TXI-153	0.090		
27-TXI-154	0.080		

#### T15

PIN NUMBER	M +0.003	A REF	D REF
15-TXI-150	0.065		
15-TXI-151	0.050		
15-TXI-152	0.075		
15-TXI-153	0.040	0.1320	0.5625
15-TXI-154	0.047		
15-TXI-155	0.037		
15-TXI-156	0.063		

#### T30

PIN NUMBER	M +0.003	A REF	D REF
30-TXI-150	0.130		
30-TXI-151	0.098		
30-TXI-152	0.110		
30-TXI-153	0.075	0.2215	0.8750
30-TXI-154	0.062		
30-TXI-155	0.048		
30-TXI-156	0.092		
30-TXI-157	0.072		

#### T20

PIN NUMBER	M +0.003	A REF	D REF
20-TXI-150	0.094		
20-TXI-152	0.085		
20-TXI-153	0.062	0.1550	0.5625
20-TXI-154	0.052		
20-TXI-155	0.065		
20-TXI-156	0.042		

#### T40

PIN NUMBER	M +0.003	A REF	D REF
40-TXI-150	0.140		
40-TXI-151	0.115		
40-TXI-152	0.130		
40-TXI-153	0.125	0.2670	0.8750
40-TXI-154	0.108		
40-TXI-155	0.090		
40-TXI-156	0.077		
40-TXI-157	0.112		

#### T25

PIN NUMBER	M +0.003	A REF	D REF
25-TXI-150	0.120		
25-TXI-151	0.070		
25-TXI-152	0.095	0.1785	0.8750
25-TXI-153	0.062		
25-TXI-154	0.088		

#### T45

PIN NUMBER	M +0.003	A REF	D REF
45-TXI-150	0.160		
45-TXI-151	0.120		
45-TXI-152	0.145		
45-TXI-153	0.115	0.3130	1.0000
45-TXI-154	0.097		
45-TXI-155	0.087		
45-TXI-156	0.142		

## FLAT TORX® PUNCHES

### ONE PIECE FLAT TORX® PUNCHES TXP-15, 15.1

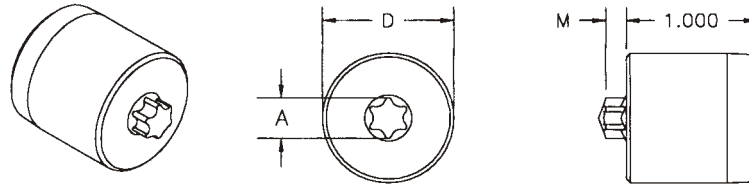

DRIVE SIZE	PIN NUMBER	M +0.003	A REF	D
T1	1-TXI-275	0.014	0.0354	0.4375
T2	2-TXI-275	0.016	0.0398	0.4375
T3	3-TXI-275	0.018	0.0478	0.4375
T4	4-TXI-275	0.022	0.0541	0.4375
T5	5-TXI-009	0.014		
T5	5-TXI-017	0.022	0.0590	0.4375
T5	5-TXI-025	0.028		
T6	6-TXI-015	0.019		
T6	6-TXI-022	0.027	0.0700	0.4375
T6	6-TXI-030	0.030		
T6	6-TXI-035	0.038		
T7	7-TXI-015	0.022		
T7	7-TXI-020	0.027		
T7	7-TXI-025	0.030		
T7	7-TXI-027	0.032	0.0825	0.4375
T7	7-TXI-030	0.035		
T7	7-TXI-035	0.040		
T8	8-TXI-018	0.025		
T8	8-TXI-020	0.027		
T8	8-TXI-025	0.030		
T8	8-TXI-028	0.035		
T8	8-TXI-030	0.032	0.0952	0.5625
T8	8-TXI-033	0.038		
T8	8-TXI-040	0.040		
T8	8-TXI-043	0.048		
T9	9-TXI-029	0.034		
T9	9-TXI-032	0.037	0.1025	0.5625
T9	9-TXI-035	0.043		
T9	9-TXI-047	0.052		

TORX® is a registered trademark of Acument Intellectual Properties, LLC

#### WARNING

Any heading punch may break or shatter under improper use. Government regulations require use of safety glasses and other appropriate safety equipment at all times in the vicinity of use.

## FLAT TORX® PUNCHES

### TAMPER RESISTANT FLAT TORX® PUNCHES TXP-19.1

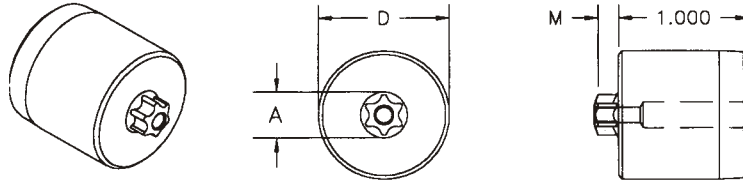

DRIVE SIZE	PIN NUMBER	M +0.003	A REF	D
T8	8-TXI-30-HX	0.032 / 0.035	0.0942	0.4375
T9	9-TXI-250-HX	0.035 / 0.040	0.1015	0.5625

TORX® is a registered trademark of Acument Intellectual Properties, LLC

#### WARNING

Any heading punch may break or shatter under improper use. Government regulations require use of safety glasses and other appropriate safety equipment at all times in the vicinity of use.

**TORX® PUNCHES**

**COMBINATION TORX® STRUCK SLOT PAN  
 HEAD PUNCHES TXP-33.4**

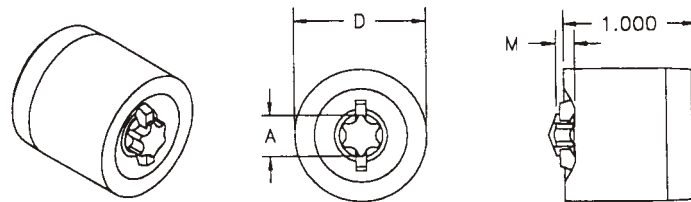

DRIVE SIZE	PIN NUMBER	M +0.004	A REF	D
T7	7-TXI-175	0.031	0.0815	
T8	8-TXI-175	0.041	0.0942	0.4375
T8	8-TXI-176	0.041	0.0942	
T9	9-TXI-175	0.040	0.1015	
T10	10-TXI-175	0.051	0.1110	
T10	10-TXI-176	0.051	0.1110	0.5625
T15	15-TXI-175	0.051	0.1320	
T20	20-TXI-175	0.060	0.1550	
T25	25-TXI-175	0.075	0.1785	
T27	27-TXI-175	0.075	0.2005	0.8750
T30	30-TXI-175	0.090	0.2215	
T40	40-TXI-175	0.110	0.2665	
T45	45-TXI-175	0.140	0.3125	1.0000

TORX® is a registered trademark of Acument Intellectual Properties, LLC

**WARNING**

Any heading punch may break or shatter under improper use. Government regulations require use of safety glasses and other appropriate safety equipment at all times in the vicinity of use.

## METRIC TORX® PUNCHES

### STRUCK SLOT TORX® PIN TMP-49A

DRIVE SIZE	PUNCH CODE	M REF.	J
T7	7TXI-170	.030	.027
T8	8TXI-170	.040	.030
T9	9TXI-170	.040	.035
T10	10TXI-170	.045	.040
T15	15TXI-170	.050	.045
T20	20TXI-170	.060	.050
T25	25TXI-170	.070	.065
T27	27TXI-170	.080	.065
T30	30TXI-170	.095	.070
T40	40TXI-170	.110	.095
T45	45TXI-170	.140	.120
T50	50TXI-170	.154	.135
T55	55TXI-170	.175	.150

### STRUCK SLOT TORX® PUNCHES TMP-51.1

DRIVE SIZE	PUNCH CODE	DIA.
T6	6TMI-175	.4375
T7	7TMI-175	.4375
T8	8TMI-175	.4375
T9	9TMI-175	.4375
T10	10TMI-175	.5625
T15	15TMI-175	.5625
T20	20TMI-175	.5625
T25	25TMI-175	.875
T27	27TMI-175	.875
T30	30TMI-175	.875
T40	40TMI-175	.875
T45	45TMI-175	1.250
T50	50TMI-175	1.250
T55	55TMI-175	1.250

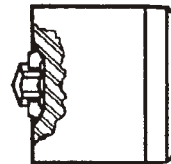
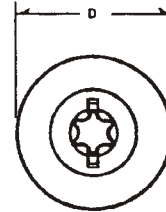
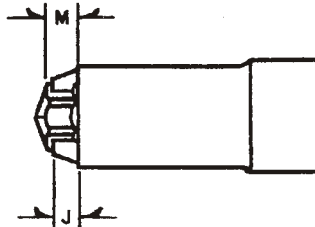
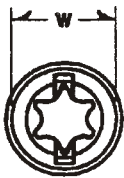

### TORX® HEX WASHER HEAD PUNCH PINS TMP-56

DRIVE SIZE	PUNCH CODE	DIA.	G REF.	H	L	W
T10	10TMI-200	.687	.045	.142	1.227	.307
T15	15TMI-200	.687	.050	.187	1.227	.307
T20	20TMI-200	.687	.065	.207	1.227	.307
T25	25TMI-200	.687	.070	.263	1.227	.371
T27	27TMI-200	.687	.080	.302	1.227	.371
T30	30TMI-200	1.250	.095	.381	1.602	.494
T40	40TMI-200	1.250	.115	.497	1.559	.619
T45	45TMI-200	1.250	.140	.575	1.559	.619

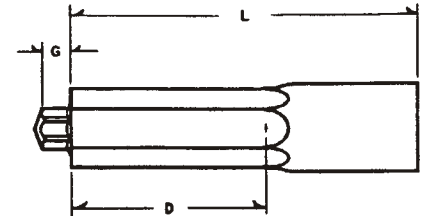

TORX® is a registered trademark of Acument Intellectual Properties, LLC

#### WARNING

Any heading punch may break or shatter under improper use. Government regulations require use of safety glasses and other appropriate safety equipment at all times in the vicinity of use.