

**SPRING PUNCHES, STEEL & CARBIDE**

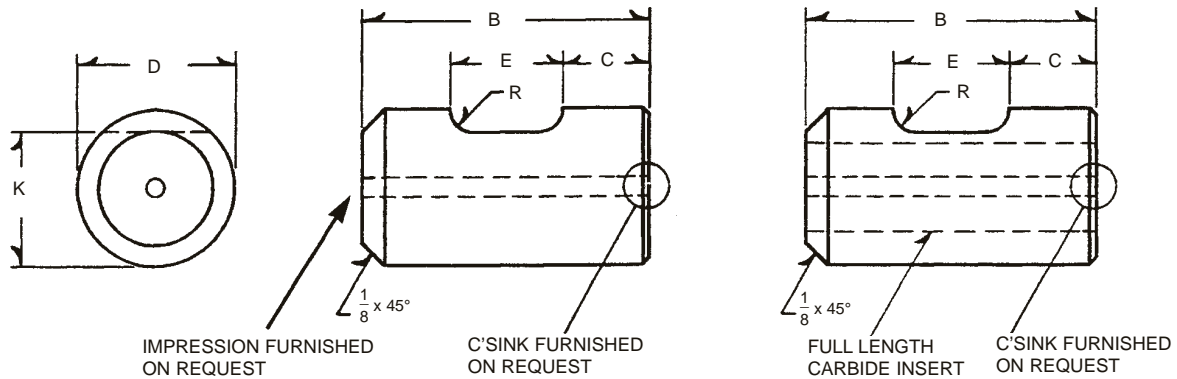

MACHINE	CODE NO.	B	D	K	R	C	E	CARBIDE DIAM.
1/8 National	SP130-S	1-17/64	.812	.720	1/8	7/32	39/64	3/8
1/8 HEADMASTER	SP130-W	1-13/32	.812	.720	3/32	7/32	39/64	3/8
0 Toggle	SP130-W	1-13/32	.812	.720	3/32	7/32	39/64	3/8
1/8 Hartford	SP130-H	1-17/64	.812	.720	1/8	—	—	3/8
3/16 HiPro	SP188-S	1-39/64	.8745	.751	1/8	31/64	3/4	1/2
H15 Nakashimada	SP188-S	1-39/64	.8745	.751	1/8	31/64	3/4	1/2
3/16 Headmaster	SP188-S	1-39/64	.8745	.751	1/8	31/64	3/4	1/2
1 Toggle	SP188-S	1-39/64	.8745	.751	1/8	31/64	3/4	1/2
SP01 Sacma	SP188-S	1-39/64	.8745	.751	1/8	31/64	3/4	1/2
3/16 National	SP188-S	1-39/64	.8745	.751	1/8	31/64	3/4	1/2
3/16 Hartford	SP188-H	1-7/8	.8745	.812	5/32	9/32	3/4	5/8
1/4 National	SP250-S	2-13/64	1.2495	1.063	1/8	23/32	31/32	5/8
SP11 Sacma	SP250-S	2-13/64	1.2495	1.063	1/8	23/32	31/32	5/8
2 Toggle	SP250-S	2-13/64	1.2495	1.063	1/8	23/32	31/32	5/8
H20 Nakashimada	SP250-S	2-13/64	1.2495	1.063	1/8	23/32	31/32	5/8
1/4 Super HiPro	SP250-SH	2-1/4	1.2495	1.059	1/8	7/16	31/32	5/8
5/16 National	SP312-S	2-3/32	1.374	1.187	5/32	7/8	55/64	3/4
SP21 Sacma	SP312-R	2-9/16	1.374	1.374	1.187	19/32	—	3/4
5/16 HiPro	SP312-W	1-15/16	1.374	1.187	5/32	7/8	—	3/4
5/16 Hartford	SP312-H	2-31/64	1.374	1.187	5/32	3/4	13/16	3/4
3/8 National	SP375-S	2-5/8	1.749	1.530	5/32	13/16	1-1/4	7/8

TO ORDER: TOOL STEEL, USE THE CODE NO. ABOVE.  
CARBIDE INSERTED, ADD "C" TO CODE NO. ABOVE.

**WARNING**

Any heading punch may break or shatter under improper use. Government regulations require use of safety glasses and other appropriate safety equipment at all times in the vicinity of use.